

"Elektrizace a zkapacitnění trati Uničov (včetně) - Olomouc"

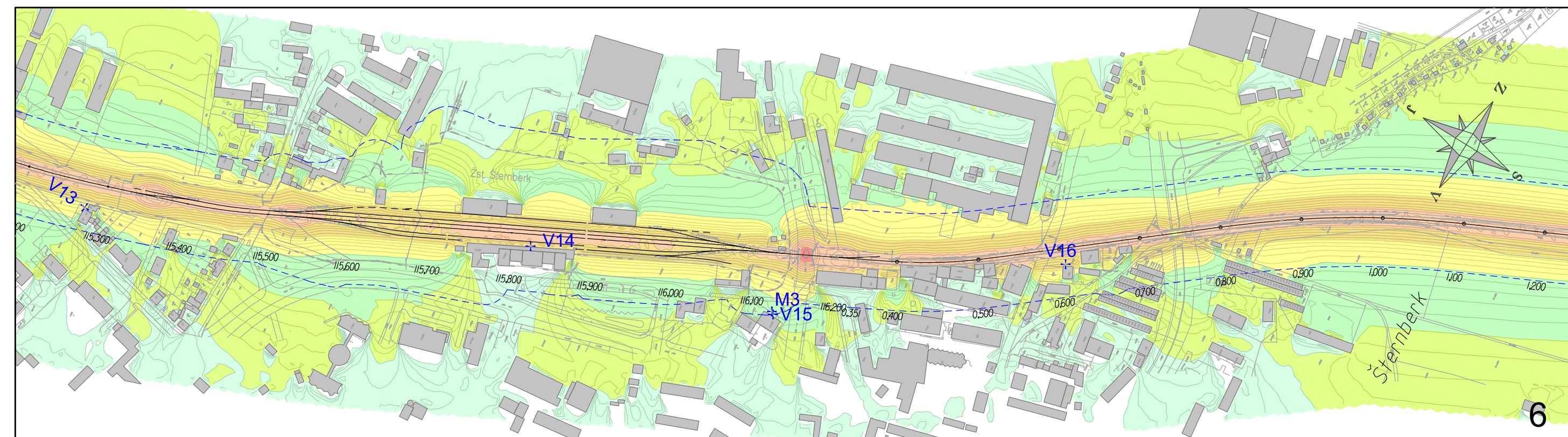

Měřítko 1 : 5 000  
hluková pásma ve výšce 3 m

Stav po rekonstrukci  
železniční doprava r. 2025  
noc 22<sup>00</sup> - 6<sup>00</sup>

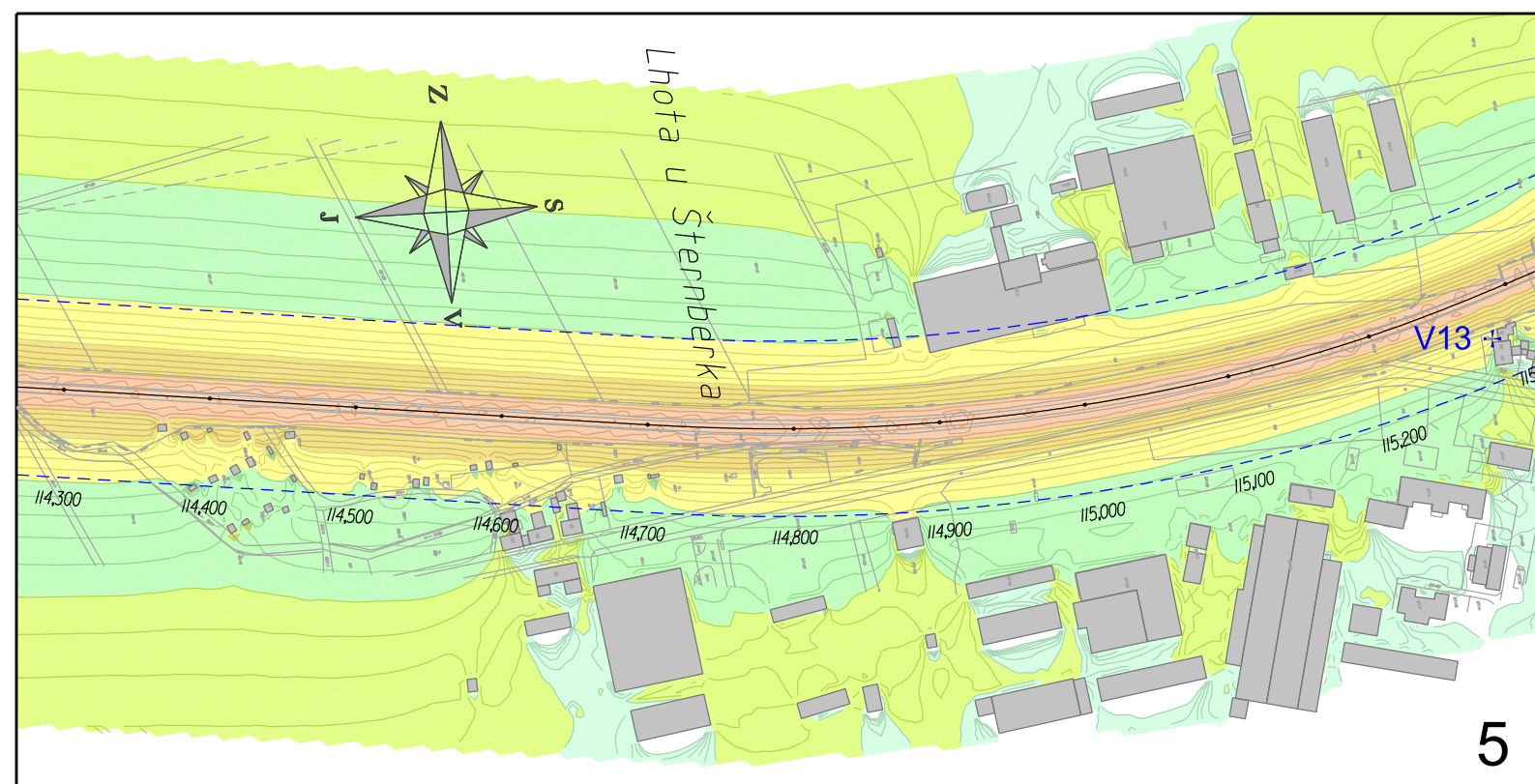
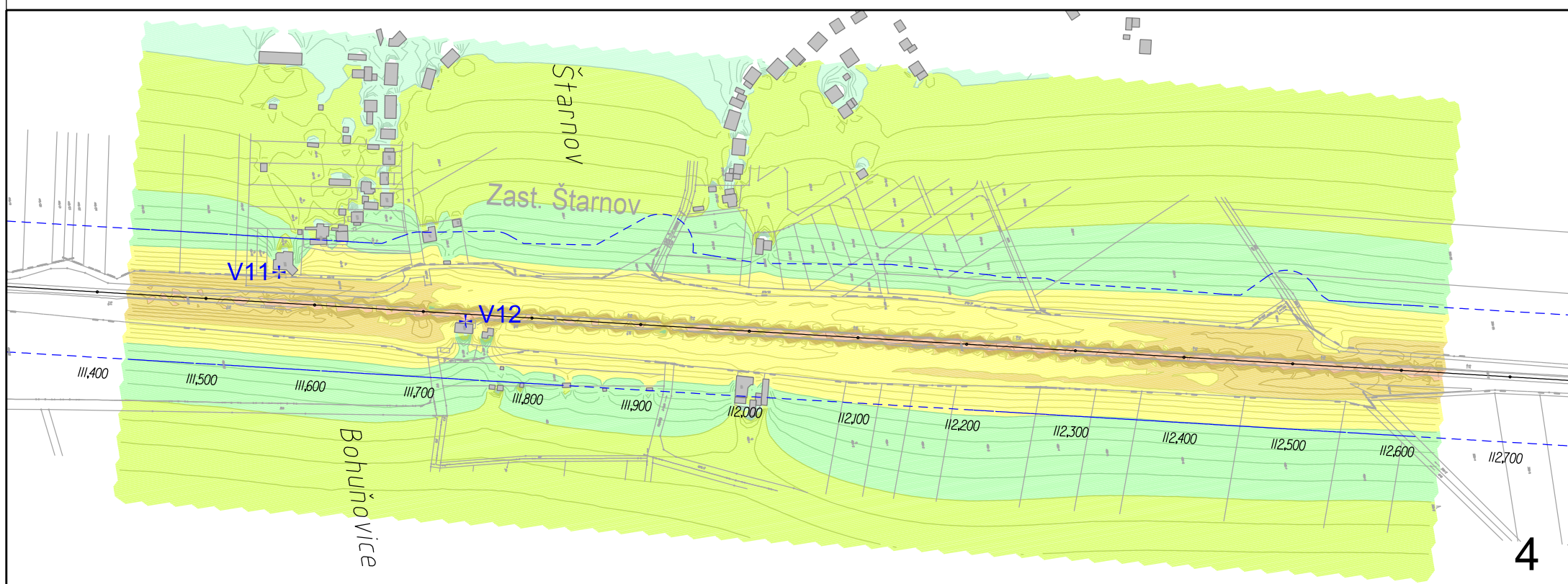
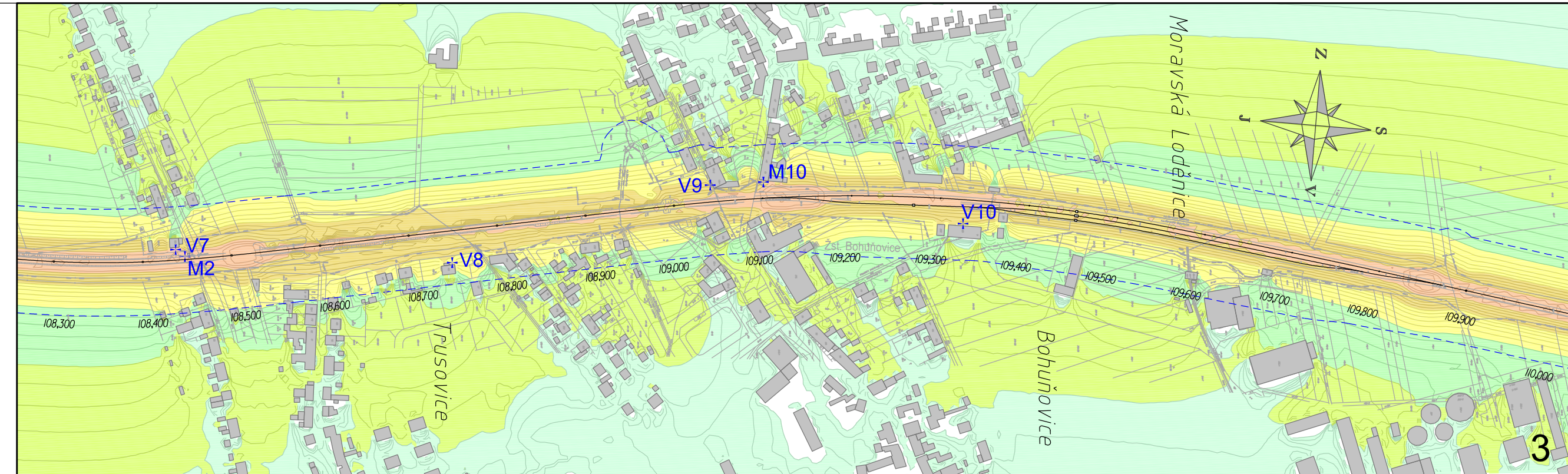
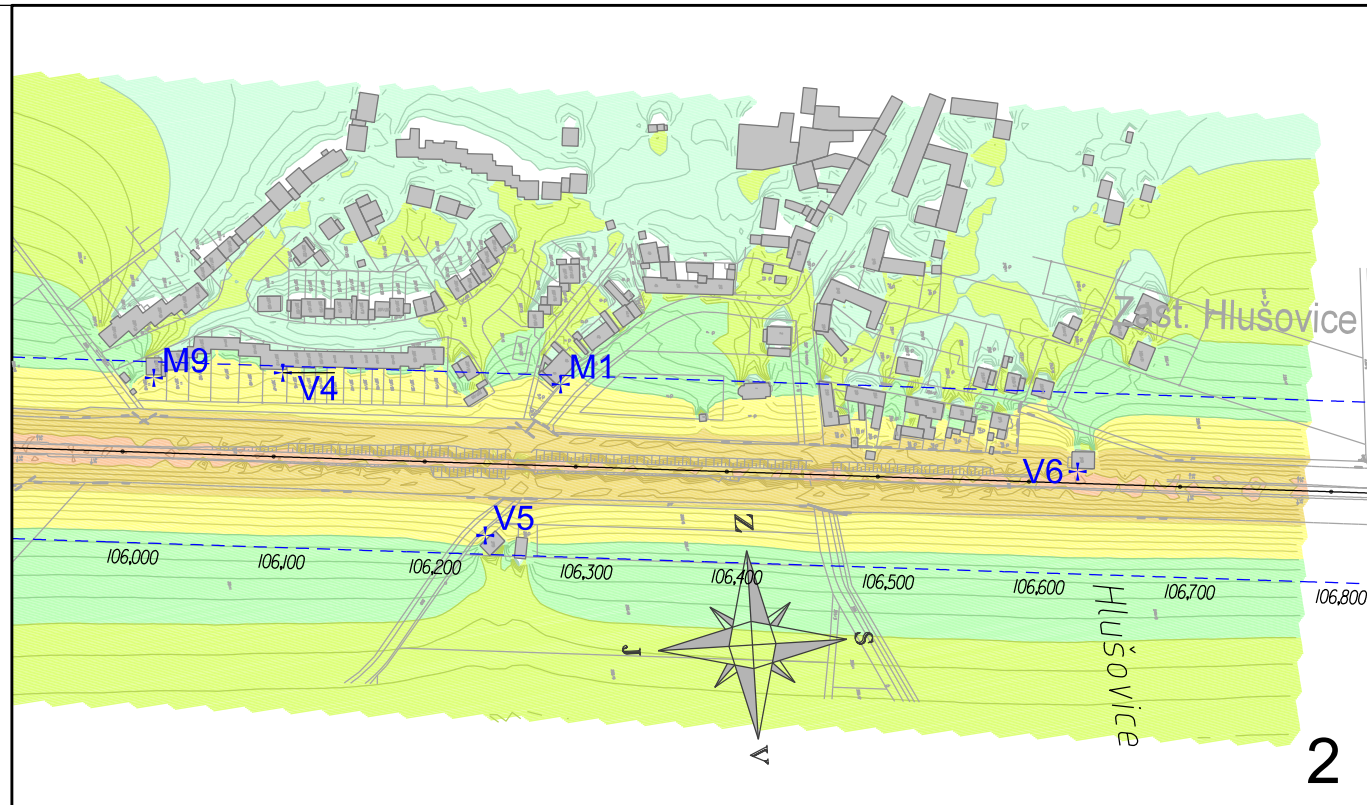
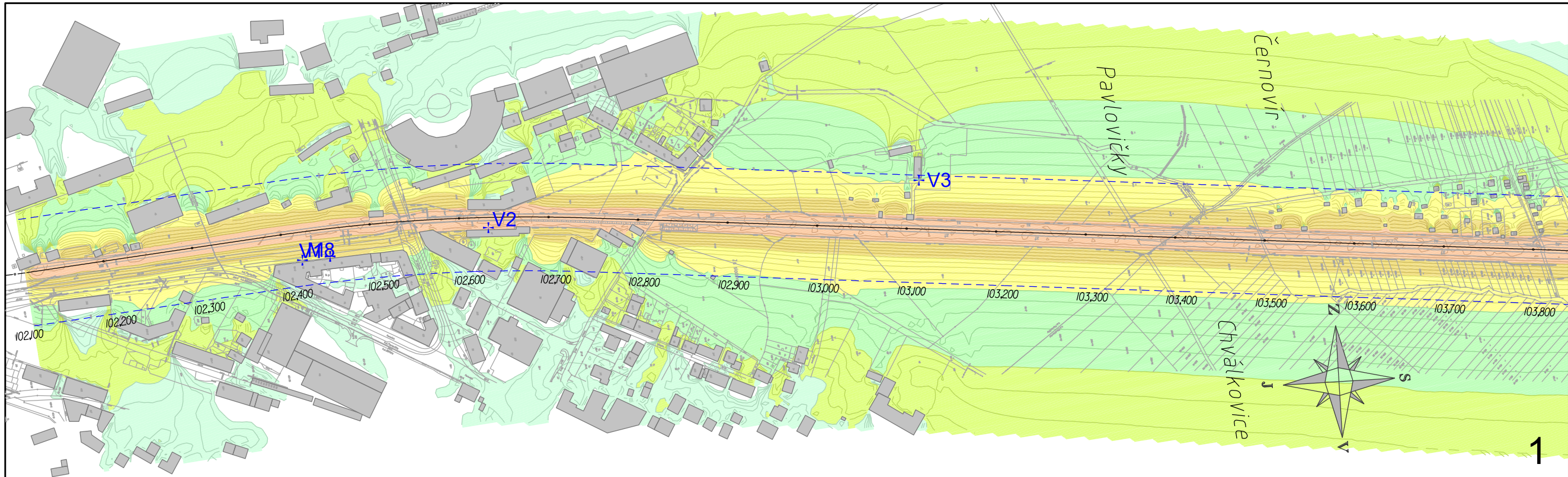
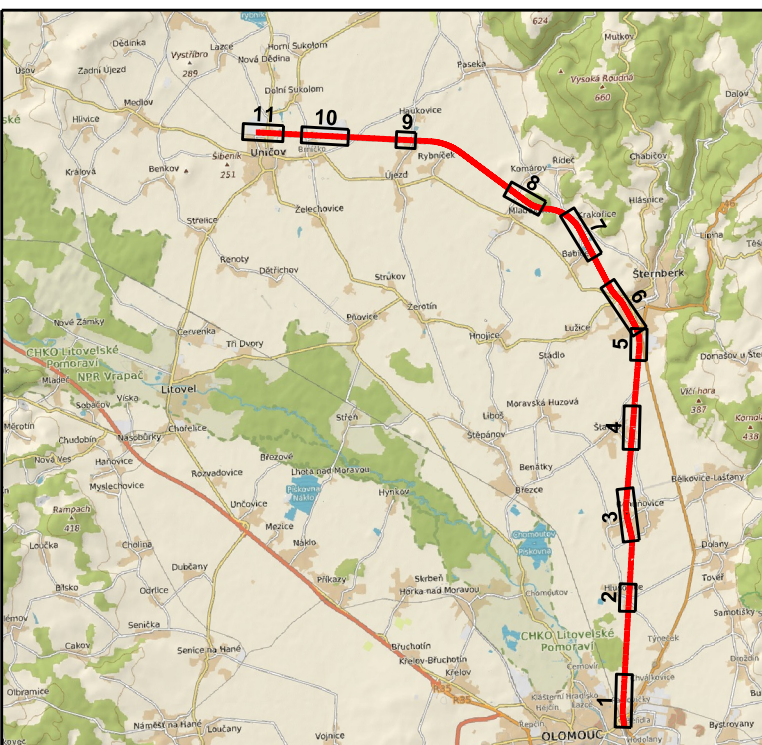

LEGENDA

80-85 dB	55-60 dB
75-80 dB	50-55 dB
70-75 dB	45-50 dB
65-70 dB	40-45 dB
60-65 dB	35-40 dB
	30-35 dB

+V1 VÝPOČTOVÝ BOD  
+M1 BOD MĚŘENÍ